

CATAMARAN CATLANTE 560



 **CATLANTE**
CATAMARANS

CATLANTE 560

DESIGNED TO MEET YOUR NEEDS

An elegant ship with bright, modular cabins.

With the 560, Catlante meets its customers' desire for a top-of-the-range catamaran that can be privatized with family or friends. Its 4 comfortable, air-conditioned passenger cabins can be adapted to suit all requirements configurations for groups of 8 to 10 people.

The two crew cabins, each with a private bathroom, can accommodate the Captain and crew, an optional host(s) for passengers wishing to add this service.

The strong points that made the Catlante 600 and 720 catamarans so successful have been taken up again: the forward nets have been replaced by a vast observation and relaxation platform, the fly-bridge offers a comfortable sunbathing area, and the large aft skirts facilitate access to the bathing area and make boarding safe, whether in port or by tender.

Thanks to its aluminum construction (a durable, recyclable material), this vessel is extremely robust.



INFORMATION & BOOKING

+33 (0)1.55.20.90.90, 9am-8pm, 7 days a week
www.catlante.com

GENERAL FEATURES

- › **Crew** : qualified Merchant Navy captain,
 - › **Optional** : Cook (also qualified sailor).

 - › **Length**: 17.06 m,
 - › **Width**: 8.49 m,
 - › **Draft**: 1.50 m,
 - › **Air draft**: 26 m,
 - › **Gauge**: UMS 55 T,
 - › **Sail area**: mainsail 104 m2, genoa 56 m2,
 - › **Aluminum construction**,
 - › **Curb weight**: 27,120 kg, Gross vehicle weight 33,350 kg,
 - › **Engines**: 2 x 110 HP Yanmar Vdrive diesel
- › **Fuel capacity**: 2800 L (in cruising mode, the vessel will carry only 500 L of fuel to avoid being weighed down. The full capacity will only be used in transit).
 - › **Water capacity**: 1290 L, drinking water capacity 195 L,
 - › **Watermaker**,
 - › **Generator**,
 - › **Photovoltaic panels**.

 - › **Leisure equipment**: 2 paddles , 1 kayak, flippers, masks, snorkels.



CABINS

4 cabins with a total capacity of 8 to 10 passengers:

- › 2 double cabins with queen-size beds 160 x 200.
- › 2 double/triple cabins, queen-size bed 160 x 200 or 2 twin beds 80 x 200, plus 1 bed 80 x 200 separated by a sliding bulkhead door for 1 optional passenger.

Each passenger cabin features a private bathroom with washbasin, separate shower and WC, hairdryer and large mirror. Cupboards and plenty of storage space, large portholes.

Individual reversible air-conditioning in each cabin.

- › 2 Crew cabins with en-suite bathroom including washbasin, shower and WC.

OUTDOOR COMMON AREAS

- › Large cockpit under flyer, open to 270° or protected by crystal-clear canvas and blackout curtains.
- › Large 2.7 x 1.3 m dining table and several bench seats.
- › Underwater lighting.
- › Integral platform foredeck without net with mattresses and fatboys.
- › Fly bridge (upper deck) with bench seat and mattress. Pilot station on fly bridge.
- › Large areas of photovoltaic panels.

INTERIOR COMMON AREAS

Semi-professional kitchen, large-capacity American fridge-freezer with water and ice dispenser, guest fridge (drinks), gas oven, microwave, dishwasher, plenty of storage space.

The kitchen is partially separate. Small living room with benches in the saloon.



CATLANTE 560 LAYOUT

The Catlante 560's design gives it avant-garde lines of great purity. Its huge windows give the cabins and interior common spaces an impressive luminosity.

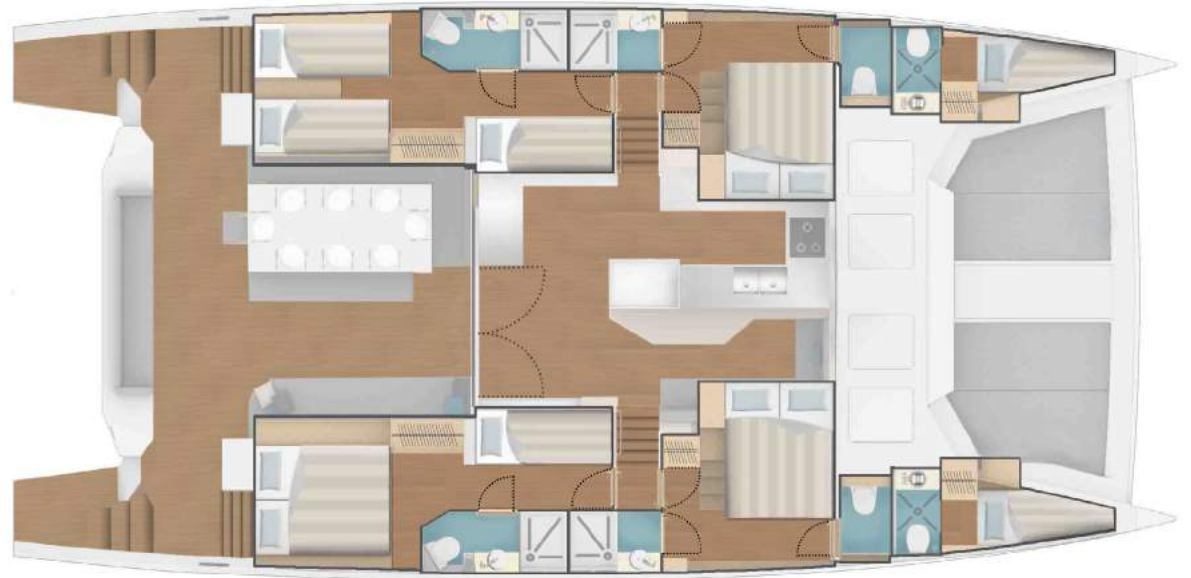
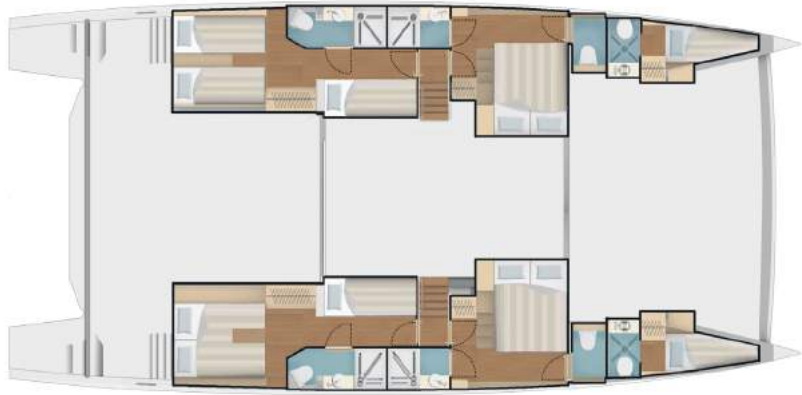



www.catlante.com

332, Les Bureaux de la Colline, 1 Rue Royale 92210 ST CLOUD
SA capital de 1.173.419 € - Rcs Nanterre 451 543 730